



PIRS – Highlights and Improvements

Release 3.81

Comment Review Sheet

Export CRS Items to Excel Template

Attachments (1) | Details | Customer & Supplier | Remarks | Workflow | Revisions (1) | Correspondence | **Comment Review Sheet (3)**

CRS Status:

CRS Responsible:

| <input type="checkbox"/> | Number | Subject | Comment | Discipline | Status | Last modified |
|--------------------------|------------------|---------------|-------------------------------|------------|--------|---------------|
| <input type="checkbox"/> | B5D-DRA-07120... | Space between | There is not enough spac... | Mechanical | Open | 09.12.2024 1 |
| <input type="checkbox"/> | B5D-DRA-07120... | Safety door | 2 Lorem ipsum dolor sit am... | Mechanical | Open | 09.12.2024 1 |
| <input type="checkbox"/> | B5D-DRA-07120... | Cable techni | Lorem ipsum dolor sit am... | Electrical | Open | 09.12.2024 1 |

Export CRS Items to customized template

| COMMENT REVIEW SHEET | | | | | | |
|---------------------------|--------------------------|---------------------------------|----------------------------|------------------------|-------------------------|--|
| Project Name | Final Project | | | | | |
| Document Number | B5D-DRA-0712025 | | | | | |
| Revision | 00 | | | | | |
| Document Title | Building 5D - Floor plan | | | | | |
| Date | 09-12-2024 | | | | | |
| CRS Item Number | CRS Item Subject | CRS Item Comment | CRS Item Discipline | CRS Item Status | CRS Reply Number | CRS Reply |
| B5D-DRA-0712025-CRS-00001 | Space between street and | There is not enough space to | Mechanical | Open | | |
| B5D-DRA-0712025-CRS-00002 | Safety door | Lorem ipsum dolor sit amet, cor | Mechanical | Open | -REP-00001 | The door must follow the DIN standard... |
| B5D-DRA-0712025-CRS-00002 | Safety door | Lorem ipsum dolor sit amet, cor | Mechanical | Open | -REP-00002 | Update to escape plan is also required |
| B5D-DRA-0712025-CRS-00003 | Cable technical room | Lorem ipsum dolor sit amet, cor | Electrical | Open | | |

Distribute Comment Review Sheet

It is possible to attach the exported CRS items **automatically** to the document:

Attachments (2) | Details | Customer & Supplier | Remarks | Workflow

+ Add ✖ Delete

File ▲

- B5D-DRA-0712025-CRS-2024-12-09-153515.xlsx (35,55 KB)
- floorplan.pdf (213,78 KB)

The generated CRS file might be distributed as Transmittal:

Subject*: Our comments to the floor plan

Ref. No.*: SOB/SOB/00078 T

Folder*: 4.00 PIRS

Your reference:

Your reference dated:

Documents (1) | Body | Attachments | Posts | Access

Add / Remove document(s) Fill document grid... Remove selected document(s) Download attachments Bulk change...

| Doc Number | Revision | Valid | Title | Document Status | Action | Required Resp... | Attachments |
|---|----------|-------|--------------------------|-------------------|------------|------------------|--|
| <input checked="" type="checkbox"/> B5D-DRA-0712025 | 00 | Yes | Building 5D - Floor plan | 21. Customer c... | For Review | 30.12.2024 | B5D-DRA-0712025-CRS-2024-12-09-153515... |

Comment Review Process with Excel Sheet Integration



External Partner

| COMMENT REVIEW Sheet | | | | | |
|----------------------|---|------------------------------------|-----------------|---------------------|--------|
| Project Name | Project XYZ | | | | |
| Document Number | P600-000-072019029-001 | | | | |
| Revision | 2 | | | | |
| Document Title | Hot water heaters Technical Requisition | | | | |
| Date | 2024-05-28 | | | | |
| CRS Item number | CRS Item subject | CRS Item Comment | CRS Item Status | CRS Item Discipline | CRS Re |
| CRS-00010 | Item 10 | General arrangements drawing for.. | Open | Mechanical | |
| CRS-00020 | Item 20 | General arrangements drawing for.. | Open | Mechanical | |
| CRS-00030 | Item 30 | General arrangements drawing for.. | Open | Mechanical | |
| CRS-00040 | Item 40 | General arrangements drawing for.. | Open | Mechanical | |
| CRS-00040 | Item 40 | General arrangements drawing for.. | Open | Mechanical | CRS-00 |
| CRS-00040 | Item 40 | General arrangements drawing for.. | Open | Mechanical | CRS-00 |
| CRS-00050 | Item 50 | General arrangements drawing for.. | Open | Mechanical | CRS-00 |

Import

| Number | Subject | Replies | Comment |
|-----------|---------|---------|------------------------------------|
| CRS-00010 | Item 10 | | General arrangements drawing for.. |
| CRS-00020 | Item 20 | | General arrangements drawing for.. |
| CRS-00030 | Item 30 | | General arrangements drawing for.. |
| CRS-00040 | Item 40 | | General arrangements drawing for.. |
| CRS-00050 | Item 50 | 1 | General arrangements drawing for.. |

Export

Note:

If the external partner has PIRS:Portal access then an import and export is usually not required. Get in contact with SOBIS to clarify which solution works best for you.

Other improvements

Show cancel button in Notification prompt

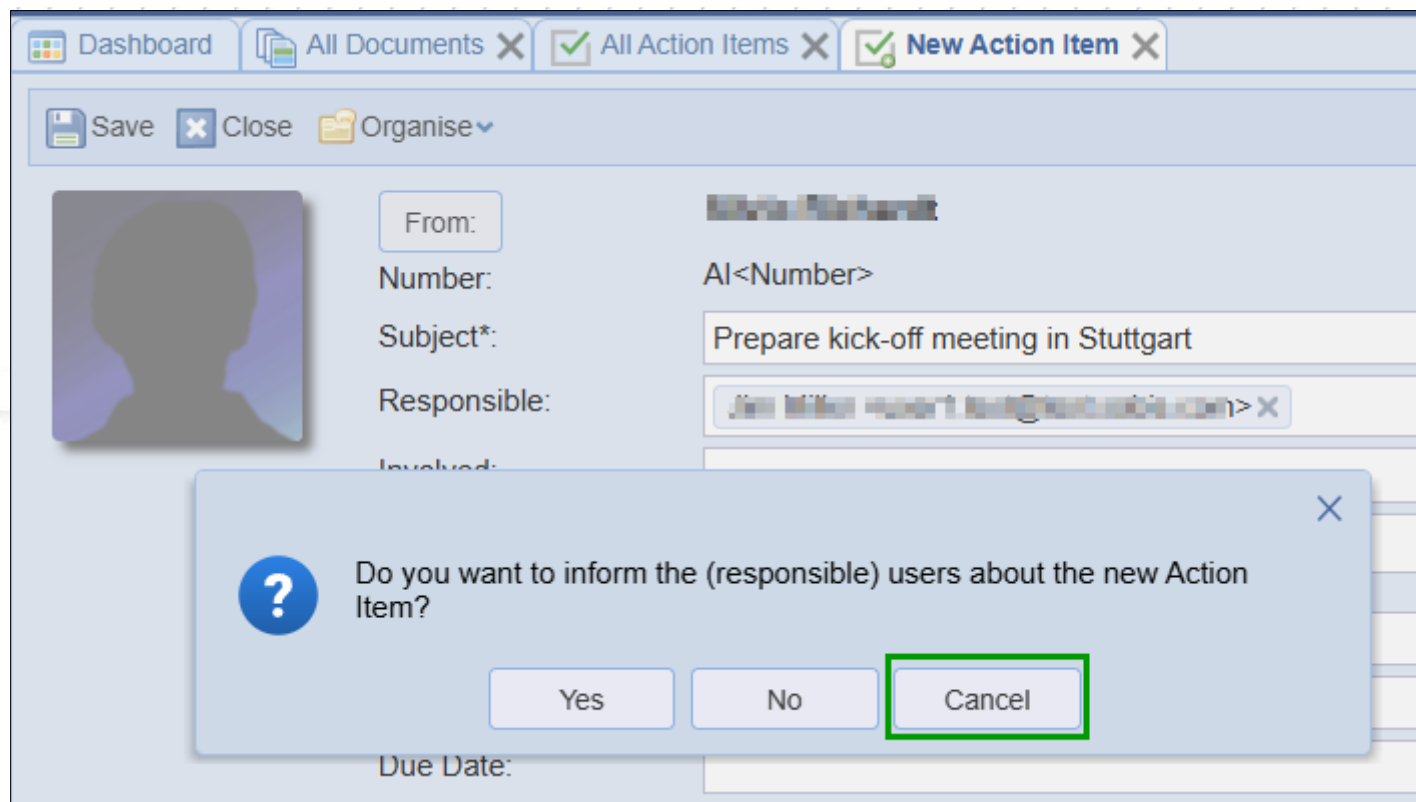

A new Cancel option allows the user to do modify the Action Item before it is saved and users get informed.